

# PRACHO

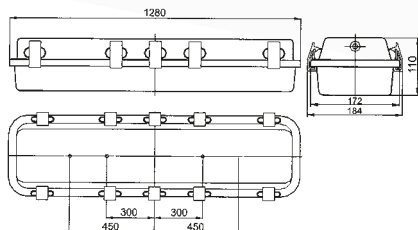

CE	⊕	IP65	EMERGENCY
Ta -25°C ÷ +40°C	VVG	EVG	EVG DIMM
Ø 26 6 13	Carton (mm/pcs): 1290 x 190 x 120 / 1		

**Use:** Light fitting for the illumination of indoor and outdoor moist, dusty industrial spaces such as halls, warehouses, workshops, corridors and cellars.

### Technical description:

The light fitting body is made of steel sheet, the caps are made of stainless steel or plastic. The optical cover is made of prismatic PC. The supporting plate with electrical equipment inside the light fitting is made of steel sheet finished with powder paint. The light fitting is designed as a through light fitting. The max. cross-section of the connecting conductors is 2.5 mm<sup>2</sup>.

### Installation:

On the ceiling, wall.

### Versions:

The light fittings are made in versions with an electromagnetic ballast (VVG), electronic ballast (EVG), electronic adjustable ballast (EVG DIMM), and emergency unit (EMERGENCY). Type 531 28 20 is designed for emergency illumination with autonomy 2 hours.

### To order:



Protective cover  
1-99.9617 PC



Plastic cap  
4-99.10213/1



Stainless steel cap  
4-99.6188/1

Type	Recommended light source [W]	Light fitting body	Cap	Socket	Weight [kg]
531 28 03 IN	3 x linear fluorescent tube T8 36	Varnished steel sheet	plastic	G13	6
531 28 13	3 x linear fluorescent tube T8 36	Varnished steel sheet	stainless	G13	6
531 28 20	3 x linear fluorescent tube T8 36	Varnished steel sheet	stainless	G13	6
531 28 19	3 x linear fluorescent tube T8 36	Stainless steel sheet	stainless	G13	6
531 41 01 (EP)	2 x linear fluorescent tube T8 36	Varnished steel sheet	plastic	G13	5
531 41 13 (EP)	2 x linear fluorescent tube T8 36	Varnished steel sheet	stainless	G13	5
531 41 19 (EP)	2 x linear fluorescent tube T8 36	Stainless steel sheet	stainless	G13	5

\*By adding the letter „K“ after the type designation, the light fittings will be equipped with protective basket (531 31 01K).

\*By adding the letters „EP“ after the type designation, the light fittings will be equipped with electronic ballasts (531 41 19 EP).

# RESIST

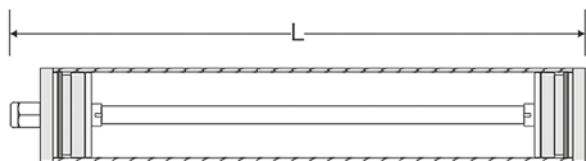
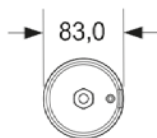

CE	⊕	IK10	IP 68-2	230V 50Hz	Ø 16 6 5	Ø 26 6 13	F	EMERGENCY
Ta -15°C ÷ +55°C	VVG	EVG	EVG DIMM	Carton (mm/pcs): 1650 x 200 x 210 / 1				

**Use:** Light fitting for the illumination of indoor and outdoor moist, dusty industrial spaces such as halls, warehouses, workshops, corridors, cellars and garages.

### Technical description:

The light fitting body is made up of a polycarbonate tube, thickness 3.5 mm, the end caps are made of nickel-plated steel. The reflector inside the light fitting is made of polished aluminium sheet. Thanks to its high degree of protection IP68, the light fitting can be immersed in water permanently up to a depth of 2 m. The max. cross-section of the connecting conductors is 2.5mm<sup>2</sup>.

### Installation:

On the ceiling, wall – with clamps, a wire suspension.

### Versions:

Light fittings are made in versions with an electromagnetic ballast (VVG), electronic ballast (EVG), electronic adjustable ballast (EVG DIMM), and with an emergency unit (EMERGENCY). Optionally, also an adjusted version for environments with a temperature of +85°C – only for types with T8 fluorescent tubes.

### To order:



Steel clamp with  
rubber coating



Stainless clamp



Wire suspension



2 polycarbonate clamps included  
in standard delivery

Type	Recommended light source [W]	Length L [mm]	Socket
RESIST-118	1 x linear fluorescent tube T8 18	709	G13
RESIST-136	1 x linear fluorescent tube T8 36	1319	G13
RESIST-158	1 x linear fluorescent tube T8 58	1624	G13
RESIST-218	2 x linear fluorescent tube T8 18	709	G13
RESIST-236	2 x linear fluorescent tube T8 36	1319	G13
RESIST-258	2 x linear fluorescent tube T8 58	1624	G13

VVG (the light fitting will be equipped with an electromagnetic ballast)

EVG (the light fitting will be equipped with an electronic ballast)

EVG DIMM (the light fitting will be equipped with an electronic dimmable ballast)

EMERGENCY (the light fitting will be equipped with an emergency unit)

# MERIDIAN/ MERIDIAN ALSi



**Use:** Light fitting for the illumination of industrial spaces such as halls, warehouses, workshops.

**Technical description:**

The light fitting body is made up of steel mouldings finished with powder paint. Electrical equipment is installed inside. The reflector is made of polished aluminium. The optical cover is made of hardened glass. The max. cross-section of the connecting conductors is 4 mm<sup>2</sup>.

**Installation:**

With a suspension eye, by suspending.

**Versions:**

Light fittings are made in versions with an electromagnetic ballast (VVG), for high-pressure sodium, halide or mercury discharge lamps.

**To order:**

CE	⊕	IP54	230V 50Hz	Ta -25°C ÷ +30°C
VVG	E40	Carton (mm/pcs): 570 x 570 x 800 / 1		



Rim with glass and sealing  
2-99.6107

Type – MERIDIAN	Recommended light source [W]	Socket	Weight [kg]
541 01 15	High-pressure sodium / halide discharge lamp 150	E40	15
541 01 25	High-pressure sodium discharge lamp 250	E40	15
541 01 26	High-pressure halide discharge lamp 250	E40	15
541 01 27	High-pressure mercury discharge lamp 250	E40	15
541 01 40	High-pressure sodium discharge lamp 400	E40	17
541 01 41	High-pressure halide discharge lamp 400	E40	17
541 01 42	High-pressure mercury discharge lamp 400	E40	17
541 01 50	Bulb CLAS 500	E40	17

Type – MERIDIAN ALSi	Recommended light source [W]	Socket	Weight [kg]
541 04 15 ALSi	High-pressure sodium / halide discharge lamp 150	E40	15
541 04 25 ALSi	High-pressure sodium discharge lamp 250	E40	15
541 04 26 ALSi	High-pressure halide discharge lamp 250	E40	15
541 04 27 ALSi	High-pressure mercury discharge lamp 250	E40	15
541 04 40 ALSi	High-pressure sodium discharge lamp 400	E40	17
541 04 41 ALSi	High-pressure halide discharge lamp 400	E40	17
541 04 42 ALSi	High-pressure mercury discharge lamp 400	E40	17
541 04 50 ALSi	Bulb CLAS 500	E40	17