

# WALL OR CEILING MOUNTING NORMALUX2

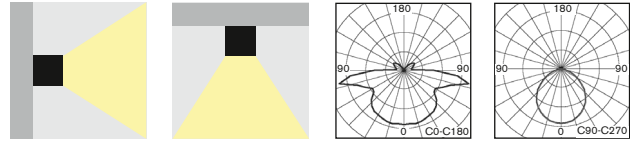

Most advanced "V" twin LED light source with perfect light distribution. It is equipped with high efficient (150lm/W) **LONGLIFE** LEDs with the lifetime min 100.000h



• **NEW Generation** of IK10 IP65 design surface mounted powerful LED fixture with perfect light distribution for all non-maintained/maintained (NM/M) or centralised (C) emergency lighting available in all following versions:

- **AUTOTEST** (-AT)
- **CENTRAL BATTERY** (C.NORMALUX2) for **non-addressable CBS** (look up page No.44)
- Conforming to the requirement of EN60598-2-22, EN1838, EN62034
- Design: PC impact resistant body
- **NOVÁ generácia** elegantného IP65 výkonného LED nůdzového svietidla s perfektnou distribúciou svetla pre trvalé/netrvalé (NM/M) alebo (C) centrálné napájané nůdzové osvetlenie dostupné vo verziách pre:
  - **AUTOTEST** (-AT)
  - **CENTRAL BATTERY** (C.NORMALUX2) pre **neadresovateľné CBS** (str.44)
- spĺňa požiadavky európskej normy EN 60598-2-22, EN1838, EN62034
- konštrukcia: teleso z nerozbitného PC

## STANDARD FEATURES

## ŠTANDARDNÁ VÝBAVA

- High efficient **MidPower (150lm/W) LONGLIFE LEDs 5000K (>100.000h)**
- **NEW Advanced Electronics**
- **LONGLIFE LiFePo4 battery**
- **Installation Mode** (battery protection, for more details look up page No.51+79)
- **Intelligent battery charging** (intermittent charging, look up page No.51+79)
- **DIP Switch** allowing to preset following functions:
  - **ECO Mode** (dimming 10%-100%, for more details look up page No.51+79)
  - **ENERGY Saving Mód** (picto illumination 2cd/m<sup>2</sup> or 200cd/m<sup>2</sup>, look up page 51+79)
- Addressable **CENTRALTEST** communication module (for ATXL, ATXP only)
- LEDs indicating presence of power supply and signaling failures + **TEST** button
- Set of self-adhesive legends (H+I+J) complying ISO7010
- **vysoce účinné MidPower LED 5000K (150lm/W) so životnosťou min.100000h**
- **progresívna elektronická jednotka**
- **LONGLIFE LiFePo4 batéria**
- **Inštaláčny mód** (ochrana batérie, pozri aj str.51+79)
- **Inteligentné nabíjanie batérie** ("intermittent" nabíjanie, pozri aj str.51+79)
- **DIP prepínač** umožňujúci prednastavenie funkcií:
  - **ECO Mód** (stmievanie 10%-100%, pozri aj str.51+79)
  - **ENERGY Saving Mód** (osvetlenie piktogramu na 2cd/m<sup>2</sup> alebo 200cd/m<sup>2</sup>, pozri str.51+79)
- adresovateľný **CENTRALTEST** komunikačný modul (len pre ATXL, ATXP verzie)
- signalizácia LED a **TEST** tlačítko
- sada samolepiacich piktogramov H+I+J v súlade s ISO7010



## OPTIONAL ACCESSORIES

## PRÍPLATKY

- Suspended plexi with single sided or double sided legend (look up page 82)
- Wall or ceiling mounting brackets (look up page No.82)
- Protective steel cage (look up page No.82)
- závesné plexi s jednostranným alebo obojstranným piktogramom (pozri str.82)
- nástenná, stropná alebo stropná závesná konzola (pozri str.82)
- ochranný kovový kôš (pozri str.82)



Optional Suspended plexi with Legends  
Príplatkové závesné plexi s piktogramom  
(look up also page No.82)

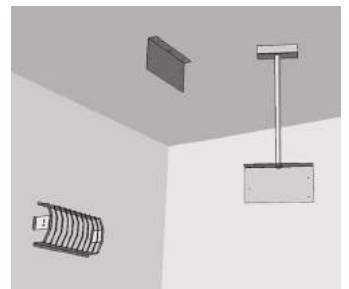

Optional Brackets and Protective Steel Cage  
Príplatkové konzoly a ochranná mreža  
(look up also page No.82)



### Input Power:

- 5,8W/ 6,1VA (maintained M)
- 2,0W/ 3,9VA (non-maintained NM)
- 5,7W/ 6,0VA (CBS)

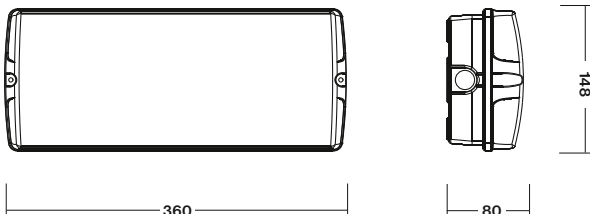

# WALL OR CEILING MOUNTING NORMALUX2



## DIP SWITCH FEATURES No.1-4 / DIP PREPÍNAČ č.1-4 - FUNKCIE

### SELF-CONTAINED BATTERY VERSIONS

<b>NORMAL MODE 230V MAINS</b>	<b>EMERGENCY BATTERY MODE</b>	<b>1 LUX ESCAPE ROUTE APPLICATION</b>	ON OFF [DIP SWITCHES 1-8]	<b>NO LEGEND / BEZ PIKTOGRAMU</b> ESCAPE ROUTE ILLUMINATION
<b>1 LUX ESCAPE ROUTE APPLICATION</b>	<b>1 LUX ESCAPE ROUTE APPLICATION</b>	ON OFF [DIP SWITCHES 1-8]	<b>DEFAULT SETT./ PREDNASTAVENÉ</b> Full Power for ESCAPE SIGN Applicaton BRIGHTNESS > 200cd/m <sup>2</sup>	
ON OFF [DIP SWITCHES 1-8]	ON OFF [DIP SWITCHES 1-8]	<b>ECO MODE 50% (in 230V mode)</b> EMERGENCY MODE LEGEND BRIGHTNESS > 200cd/m <sup>2</sup>		
ON OFF [DIP SWITCHES 1-8]	ON OFF [DIP SWITCHES 1-8]	<b>ECO MODE 25% (in 230V mode)</b> EMERGENCY MODE LEGEND BRIGHTNESS > 200cd/m <sup>2</sup>		
ON OFF [DIP SWITCHES 1-8]	ON OFF [DIP SWITCHES 1-8]	<b>ECO MODE 10% (in 230V mode)</b> EMERGENCY MODE LEGEND BRIGHTNESS > 200cd/m <sup>2</sup>		
ON OFF [DIP SWITCHES 1-8]	ON OFF [DIP SWITCHES 1-8]	<b>ENERGY SAVING (in emerg.mode)</b> LEGEND BRIGHTNESS > 2cd/m <sup>2</sup> JAS PIKTOGRAMU > 2cd/m <sup>2</sup>		
ON OFF [DIP SWITCHES 1-8]	ON OFF [DIP SWITCHES 1-8]	<b>ENERGY SAVING (in emerg.mode)</b> <b>ECO MODE 50% (in 230V mode)</b> LEGEND BRIGHTNESS > 2cd/m <sup>2</sup>		
ON OFF [DIP SWITCHES 1-8]	ON OFF [DIP SWITCHES 1-8]	<b>ENERGY SAVING (in emerg.mode)</b> <b>ECO MODE 25% (in 230V mode)</b> LEGEND BRIGHTNESS > 2cd/m <sup>2</sup>		
ON OFF [DIP SWITCHES 1-8]	ON OFF [DIP SWITCHES 1-8]	<b>ENERGY SAVING (in emerg.mode)</b> <b>ECO MODE 10% (in 230V mode)</b> LEGEND BRIGHTNESS > 2cd/m <sup>2</sup>		
<b>INSTALLATION MODE SET UP</b>	ON OFF [DIP SWITCHES 1-8]	<b>DEFAULT / PREDNASTAVENÉ</b> OFF - ACTIVATED ON - DEACTIVATED		
<b>M / NM</b>	ON OFF [DIP SWITCHES 1-8]	<b>DEFAULT / PREDNASTAVENÉ</b> ON - MAINTAINED OFF - NON-MAINTAINED		
<b>AT / ATXL</b>	ON OFF [DIP SWITCHES 1-8]	<b>DEFAULT / PREDNASTAVENÉ</b> OFF - AUTOTEST ON - CENTRALTEST		
<b>NO AT</b>	ON OFF [DIP SWITCHES 1-8]	<b>DEFAULT / PREDNASTAVENÉ</b> OFF - AUTOTEST ACTIVE ON - NO-AUTOTEST		

### CBS CENTRAL BATTERY VERSIONS

<b>CBS CENTRAL BATTERY</b>	<b>1 LUX ESCAPE ROUTE APPLICATION</b>	ON OFF [DIP SWITCHES 1-8]	<b>FULL POWER</b> PLNÝ VÝKON
ON OFF [DIP SWITCHES 1-8]	ON OFF [DIP SWITCHES 1-8]	<b>FULL POWER</b> LEGEND BRIGHTNESS > 200cd/m <sup>2</sup> JAS PIKTOGRAMU > 200cd/m <sup>2</sup>	
ON OFF [DIP SWITCHES 1-8]	ON OFF [DIP SWITCHES 1-8]	<b>ECO MODE 50%</b>	
ON OFF [DIP SWITCHES 1-8]	ON OFF [DIP SWITCHES 1-8]	<b>ECO MODE 25%</b>	
ON OFF [DIP SWITCHES 1-8]	ON OFF [DIP SWITCHES 1-8]	<b>ECO MODE 10%</b> LEGEND BRIGHTNESS > 2cd/m <sup>2</sup> JAS PIKTOGRAMU > 2cd/m <sup>2</sup>	
<b>L1' Logic</b>	<b>L1' FUNCT. LOGIC SET UP</b>	ON OFF [DIP SWITCHES 1-8]	<b>ONLY FOR CBS VERSIONS</b> ON - NEGATIVE OFF - POSITIVE

TO SEE THE CHANGE EITHER PUSH THE TEST BUTTON OR DISCONNECT THE FIXTURE FROM BOTH THE MAINS 230V AND BATTERY

Po prestavení stlačte TEST alebo odpojte batériu a pripojenie na sieť na aktiváciu zmeny



Parking Garage Area Emergency Lighting Application

Page No.32

## AUTOTEST -AT NM/M

Type	Version	Duration	Light Source	Light Flux / Emergency mode	Battery	Order Code	Weight
MULTINORMA2-AT.1h	NM/M	1h	LED	350 lm / 310 lm	LiFePo4 6,4V/1,0Ah	252-B-100-04-00-00	1,5 kg
MULTINORMA2-AT.3h	NM/M	3h	LED	350 lm / 310 lm	LiFePo4 6,4V/2,0Ah	252-B-101-04-00-00	1,6 kg

Page No.44

## CENTRAL BATTERY (CBS)

Type	Version	Light Source	Light Flux	Order Code	Weight
C.NORMALUX2 230V AC/DC	CBS NON-ADDRESSABLE	LED	760 lm	252-B-106-00-00-00	1,2 kg
C.NORMALUX2 24V AC/DC	CBS NON-ADDRESSABLE	LED	760 lm	252-B-107-00-00-00	1,2 kg

Look up pages No. 210-217 for 1lx Spacing tables  
Pozri str.210-217 pre rozmiestnenie svietidiel na dosiahnutie 1lx

WALL OR CEILING MOUNTING  
NORMALUX2



Light source	LED 5000K >500cd/m <sup>2</sup> (white luminance) >200cd/m <sup>2</sup> (average luminance)
Installed load	5.8W/6.1VA (maintained M) 2.0W/3.9VA (non-maintained NM) 6.3W/6.5VA (CBS)
Protection type	IP65
Housing material	Impact resistant polycarbonate
Viewing distance	32/35m

## CEILING MOUNTING WITH SUSPENDED LEGEND NORMALUX2



# ACCESSORIES NORMALUX2



- Suspended plexi with single or double sided legend complying ISO7010
- Viewing Distance: 35m
- závesné plexi s jednostranným alebo obojstranným piktogramom v súlade s ISO7010
- rozoznatelnosť piktogramu: 35m

Optional Item / Príplatok	Order Code / Objednávaci kód
Suspended plexi H/J doublesided / obojstranné	252-B-23-05
Suspended plexi I doublesided / obojstranné	252-B-23-01
Suspended plexi H singlesided / jednostranné	252-B-23-06
Suspended plexi I singlesided / jednostranné	252-B-23-04
Suspended plexi J singlesided / jednostranné	252-B-23-07
Suspended plexi K/M doublesided / obojstranné	252-B-23-08
Suspended plexi L/N doublesided / obojstranné	252-B-23-09
Suspended plexi K singlesided / jednostranné	252-B-23-10
Suspended plexi L singlesided / jednostranné	252-B-23-11
Suspended plexi M singlesided / jednostranné	252-B-23-12
Suspended plexi N singlesided / jednostranné	252-B-23-13
Suspended plexi O singlesided / jednostranné	252-B-23-16
Suspended plexi O doublesided / obojstranné	252-B-23-17
Suspended plexi Z1 doublesided / obojstranné	252-B-23-21
Suspended plexi Z2 doublesided / obojstranné	252-B-23-22

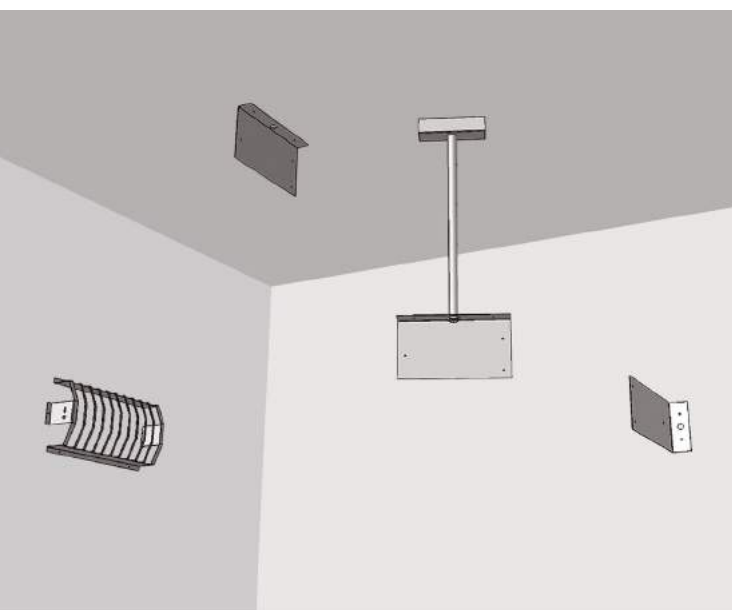
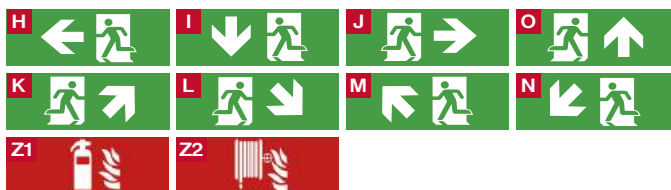

#### Options:

- Wall / Ceiling / Pendant mounting bracket
- Protective Steel Cage

#### Príplatky:

- nástenná / stropná / závesná konzola
- ochranný kôš

Optional Item : Príplatok :	Order Code : objednávaci kód :
Wall mounting bracket / nástenná konzola RAL9003	252-B-22-00
Ceiling mounting bracket / stropná konzola RAL9003	252-B-22-01-01
Ceiling mounting bracket / stropná konzola RAL9006	252-B-22-01
Pendant bracket 0,5m / závesná konzola 0,5m RAL9003	252-B-22-12-01
Pendant bracket 0,5m / závesná konzola 0,5m RAL9006	252-B-22-12-02
Pendant bracket 0,65m / závesná konz. 0,65m RAL9006	252-B-22-09
Pendant bracket 1,0m / závesná konzola 1,0m RAL9003	252-B-22-10-01
Pendant bracket 1,5m / závesná konzola 1,5m RAL9003	252-B-22-11-01
Protective steel cage / ochranný kôš RAL9003	252-B-22-05

# CEILING MOUNTING WITH SUSPENDED LEGEND NORMALUX2

Parking garage area emergency lighting application

Light source	LED 5000K >500cd/m <sup>2</sup> (white luminance) >200cd/m <sup>2</sup> (average luminance)
Installed load	5.8W/6.1VA (maintained M) 2.0W/3.9VA (non-maintained NM) 6.3W/6.5VA (CBS)
Protection type	IP65
Housing material	Impact resistant polycarbonate
Viewing distance	32/35m

