

# DESIGN FEATURES TRENDLUX2

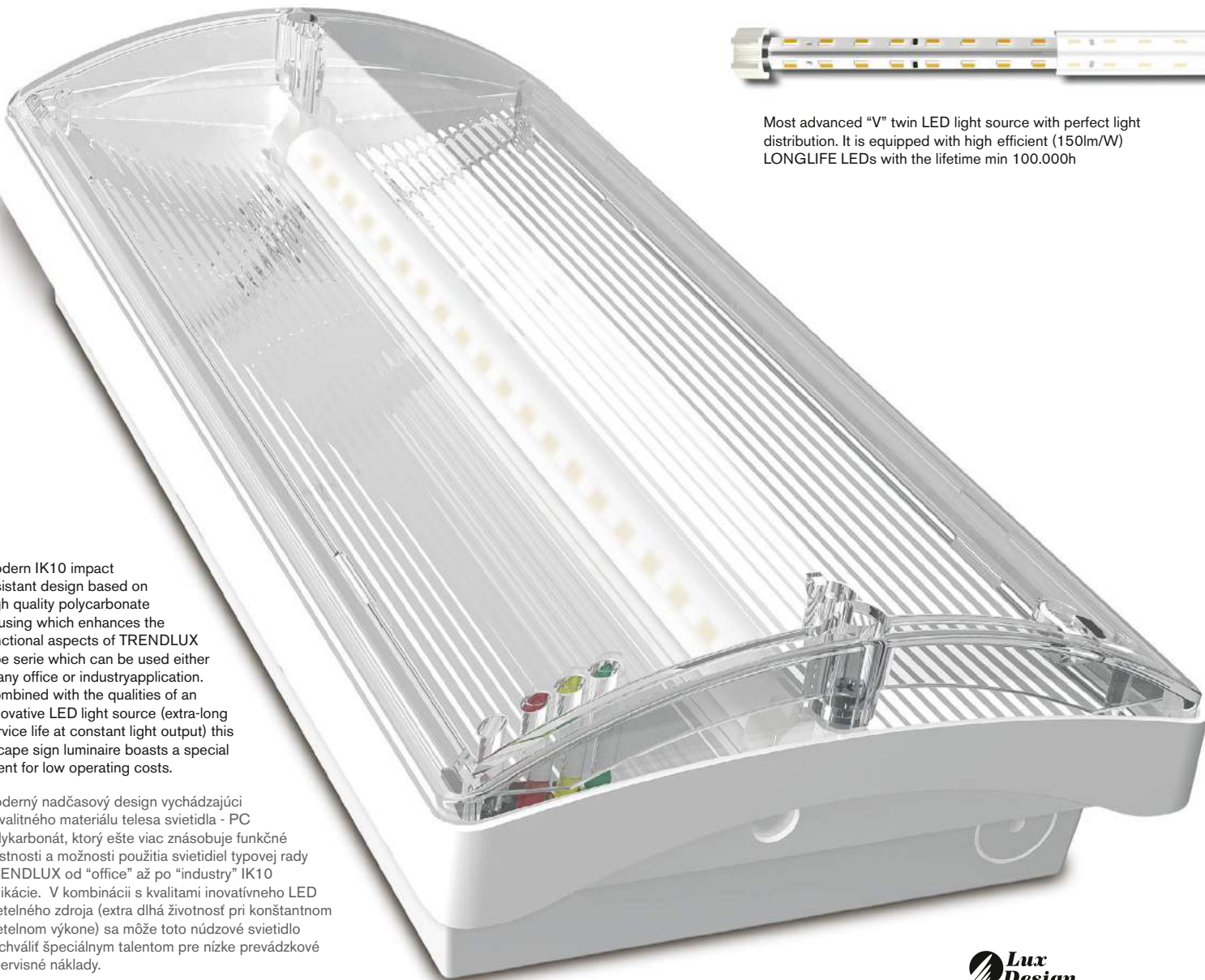

Most advanced "V" twin LED light source with perfect light distribution. It is equipped with high efficient (150lm/W) **LONGLIFE** LEDs with the lifetime min 100.000h

Modern IK10 impact resistant design based on high quality polycarbonate housing which enhances the functional aspects of TRENDLUX type serie which can be used either in any office or industry application. Combined with the qualities of an innovative LED light source (extra-long service life at constant light output) this escape sign luminaire boasts a special talent for low operating costs.

Moderný nadčasový design vychádzajúci z kvalitného materiálu telesa svietidla - PC polykarbonát, ktorý ešte viac znásobuje funkčné vlastnosti a možnosti použitia svietidiel typovej rady TRENDLUX od "office" až po "industry" IK10 aplikácie. V kombinácii s kvalitami inovatívneho LED svetelného zdroja (extra dlhá životnosť pri konštantnom svetelnom výkone) sa môže toto núdzové svietidlo pochváliť špeciálnym talentom pre nízke prevádzkové a servisné náklady.

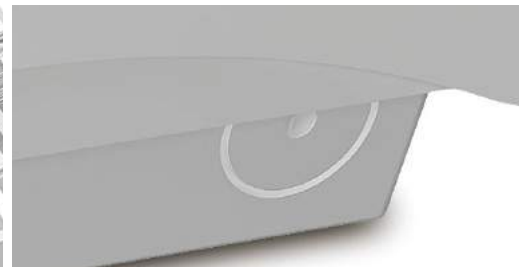
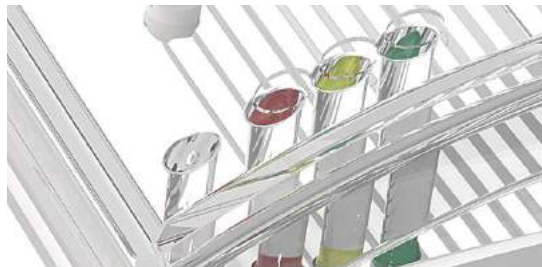
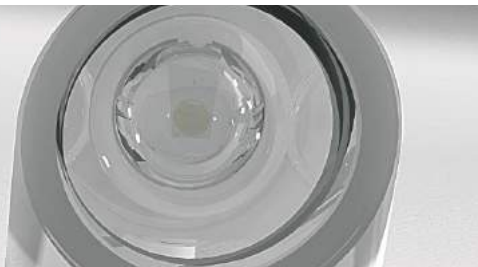

**Additional 2pcs of Power LEDs** which arrange perfect light distribution downward in order to get more light on the floor for wall mounting version. Or in case of legend on the diffuser the additional LEDs will arrange enough light level on the floor below the fixture.

Pridavné 2 výkonné LED, ktoré zabezpečujú výkonné osvetlenie podlahy v prípade montáže na stenu, čo môže byť s výhodou použité aj v kombinácii s piktogramom. Tri LED nasvetia piktogram, spodné 2 LED zabezpečia nasvetlenie únikovej cesty na dosiahnutie 1lx.

**AUTOTEST/CENTRALTEST**  
Monitor status by 3x LEDs  
and TEST button

**AUTOTEST/CENTRALTEST**  
3x LED pre signalizáciu stavu  
svietidla a TEST tlačítko

**There are in total 6 cable entries:**  
4 side ones around the body  
and 2 from the back side.

Na telese svietidla sa nachádzajú 4 prechodky po obvode svietidla a 2 zo zadnej strany telesa svietidla.

# DESIGN FEATURES TRENDLUX2



Light source	LED 5000K >500cd/m <sup>2</sup> (white luminance) >200cd/m <sup>2</sup> (average luminance)
Installed load	5.8W/6.1VA (maintained M) 2.0W/3.9VA (non-maintained NM) 6.3W/6.5VA (CBS)
Protection type	IP65 IK10
Housing material	Impact resistant polycarbonate
Viewing distance	35m
Application	Escape route lighting
Max luminaire spacing	up to <b>12,7m &gt; 1lx</b>



**ENERGY SAVING  
ECO MODE  
SET UP**



**2/200  
cd/m<sup>2</sup>**

**NO  
AT**

## DIP SWITCH FEATURES No.1-8 / DIP PŘEPÍNAČ č.1-8 - FUNKCIE

### SELF-CONTAINED BATTERY VERSIONS

#### NORMAL MODE 230V MAINS

#### EMERGENCY BATTERY MODE

**+2xLED  
BOTTOM LEDs  
ACTIVATION**



**+2xBOTTOM LEDs ACTIVATION in 230V**  
ON - ACTIVATED  
OFF - DEACTIVATED



**DEFAULT SETT./ PREDNASTAVENÉ**  
Full Power



**ECO MODE 50% (in 230V mode)**  
EMERGENCY MODE LEGEND  
BRIGHTNESS > 200cd/m<sup>2</sup>



**ECO MODE 25% (in 230V mode)**  
EMERGENCY MODE LEGEND  
BRIGHTNESS > 200cd/m<sup>2</sup>



**ECO MODE 10% (in 230V mode)**  
EMERGENCY MODE LEGEND  
BRIGHTNESS > 200cd/m<sup>2</sup>



**ENERGY SAVING (in emerg.mode)**  
LEGEND BRIGHTNESS > 2cd/m<sup>2</sup>  
JAS PIKTOGRAMU > 2cd/m<sup>2</sup>



**ENERGY SAVING (in emerg.mode)**  
**ECO MODE 50% (in 230V mode)**  
LEGEND BRIGHTNESS > 2cd/m<sup>2</sup>



**ENERGY SAVING (in emerg.mode)**  
**ECO MODE 25% (in 230V mode)**  
LEGEND BRIGHTNESS > 2cd/m<sup>2</sup>



**ENERGY SAVING (in emerg.mode)**  
**ECO MODE 10% (in 230V mode)**  
LEGEND BRIGHTNESS > 2cd/m<sup>2</sup>



**INSTALLATION  
MODE  
SET UP**



**DEFAULT / PREDNASTAVENÉ**  
OFF - ACTIVATED  
ON - DEACTIVATED

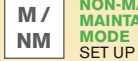

**M /  
NM**  
NON-MAINTAINED /  
MAINTAINED  
MODE  
SET UP

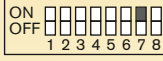

**DEFAULT / PREDNASTAVENÉ**  
ON - MAINTAINED  
OFF - NON-MAINTAINED



**AT /  
ATXL**  
AUTOTEST /  
CENTRALTEST  
MODE  
SET UP



**DEFAULT / PREDNASTAVENÉ**  
OFF - AUTOTEST  
ON - CENTRALTEST



**NO  
AT**  
NO-AUTOTEST  
MODE  
SET UP



**DEFAULT / PREDNASTAVENÉ**  
OFF - AUTOTEST ACTIVE  
ON - NO-AUTOTEST

### CBS CENTRAL BATTERY VERSIONS

#### CBS CENTRAL BATTERY

**1 LUX  
ESCAPE ROUTE  
APPLICATION**



**FULL POWER**  
PLNY VÝKON



**FULL POWER**  
LEGEND BRIGHTNESS > 200cd/m<sup>2</sup>  
JAS PIKTOGRAMU > 200cd/m<sup>2</sup>



**ECO MODE 50%**



**ECO MODE 25%**



**ECO MODE 10%**  
LEGEND BRIGHTNESS > 2cd/m<sup>2</sup>  
JAS PIKTOGRAMU > 2cd/m<sup>2</sup>



**L1'  
Input**

**INPUT L1'  
FUNCT.  
SET UP**



**ONLY FOR CBS VERSIONS**  
ON - +2 BOTTOM LEDs CONTROL  
OFF - DIMMING

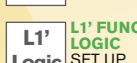

**L1'  
Logic**

**L1' FUNCT.  
LOGIC  
SET UP**

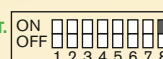

**ONLY FOR CBS VERSIONS**  
ON - NEGATIVE  
OFF - POSITIVE

**TO SEE THE CHANGE EITHER PUSH THE TEST BUTTON OR  
DISCONNECT THE FIXTURE FROM BOTH THE MAINS 230V AND BATTERY**

Po prestavení stlačte TEST alebo odpojte batériu a pripojenie na sieť na aktiváciu zmeny

# WALL OR CEILING MOUNTING TRENDLUX2

← → 35m

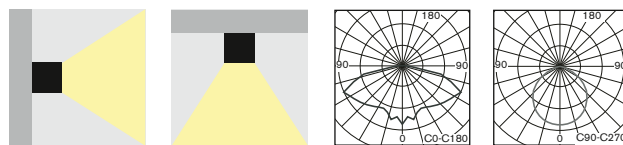

• **Impact resistant** surface or semi-recessed mounted powerful LED fixture with perfect light distribution for all non-maintained/maintained (NM/M) or centralised (C) emergency lighting available in all following versions:

- **AUTOTEST** (-AT)
- **DALI**
- **CENTRALTEST** (-ATXL) for ELMAX LOOK system (look up also page No.36)
- **CENTRAL BATTERY** (C.TRENDLUX) for **non-addressable CBS** (page No.44)
- **CENTRAL BATTERY** (-ATXP) for system **ELMAX-PATROLUX & Addressable CBS** (look up also page No.40)
- Conforming to the requirement of EN60598-2-22, EN1838, EN62034
- Design: Mirror effect AL reflector & PC impact resistant body

• **Mechanicky odolné IK10** výkonné LED núdzové svietidlo s perfektnou distribúciou svetla pre trvalé/netrvalé (NM/M) alebo (C) centrálné napájané núdzové osvetlenie dostupné vo verziách pre:

- **AUTOTEST** (-AT)
- **DALI**
- **CENTRALTEST** (-ATXL) pre systém ELMAX LOOK (pozri str.36)
- **CENTRAL BATTERY** (C.TRENDLUX) pre **neadresovateľné CBS** (str.44)
- **CENTRAL BATTERY** (-ATXP) pre systém **ELMAX-PATROLUX s adresovateľnou CBS** (pozri str. 40)

• spĺňa požiadavky európskej normy EN 60598-2-22, EN1838, EN62034  
• konštrukcia: vysokoleštený AL reflektor a teleso z nerozbitného PC

## STANDARD FEATURES

## STANDARDNÁ VÝBAVA

- **High efficient MidPower (150lm/W) LONGLIFE LEDs 5000K (>100.000h)**
- **2pcs of High-Power bottom LEDs** 120lm/W for floor escape route illumination (valid only for all "+2xLED" versions)
- **NEW Advanced Electronics**
- **LONGLIFE LiFePo4 battery**
- **Installation Mode** (battery protection, for more details look up page No.50+69)
- **Intelligent battery charging** (intermittent charging, look up page No.50+69)
- **DIP Switch** allowing to preset following functions:
  - **ECO Mode** (dimming 10%-100%, for more details look up page No.50+69)
  - **ENERGY Saving Mode** (picto illumination 2cd/m<sup>2</sup> or 200cd/m<sup>2</sup>, look up page 50+69)
  - **2 bottom LEDs control** (ON/OFF during operation on mains 230V, page No.50+69)
- Special mirror effect reflector
- Addressable CENTRALTEST communication module (for ATXL, ATXP only)
- LEDs indicating presence of power supply and signaling failures + TEST button
- **vysoko účinné MidPower LED 5000K (150lm/W) so životnosťou min.100000h**
- **2 výkonné LED 120lm/W pre osvetlenie únikovej cesty na podlahe** (len pri všetkých "+2xLED" verziách)
- **progresívna elektronická jednotka**
- **LONGLIFE LiFePo4 batéria**
- **Inštalovaný mód** (ochrana batérie, pozri aj str.50+69)
- **Inteligentné nabíjanie batérie** ("intermittent" nabíjanie, pozri aj str.50+69)
- **DIP prepínač** umožňujúci prednastavenie funkcií:
  - **ECO Mód** (stmievanie 10%-100%, pozri aj str.50+69)
  - **ENERGY Saving Mód** (osvetlenie picto na 2cd/m<sup>2</sup> alebo 200cd/m<sup>2</sup>, pozri aj str.50+69)
- ovládanie **2 spodných LED** (zap/vyp počas normálneho režimu 230V)
- špeciálny odrazový reflektor so zrkadlovým efektom
- adresovateľný CENTRALTEST komunikačný modul (len pre ATXL, ATXP verzie)
- signalizácia LED a TEST tlačítko

## OPTIONAL ACCESSORIES

## PRÍPLATKY

- Non-adhesive legends & Mounting brackets (look up page No.72)
- fóliové piktogramy a montážne konzoly (pozri str.72)



### Input Power:

- 5,8W/ 6,1VA (maintained M)
- 2,0W/ 3,9VA (non-maintained NM)
- 6,3W/ 6,5VA (CBS)

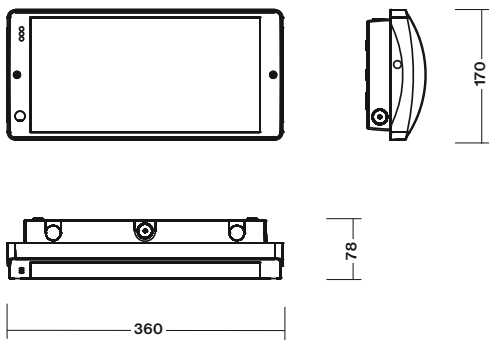

Optional Foil Legends  
Príplatkový piktogram  
(look up also page No.72)



Optional Semi-recessed accessories  
Príplat.prísluž. pre polozapust. montáž  
(look up also page No.72)

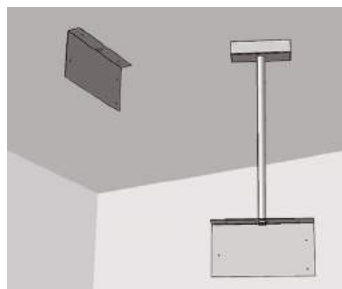

Optional Brackets  
Príplatkové konzoly  
(look up also page No.72)

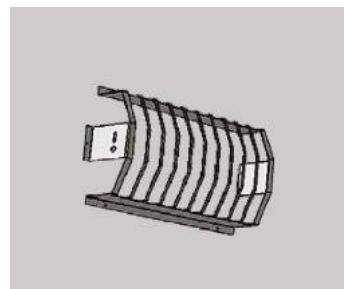

Optional Protective Cage  
Príplatková ochranná mreža  
(look up also page No.72)



## WALL OR CEILING MOUNTING TRENDLUX2

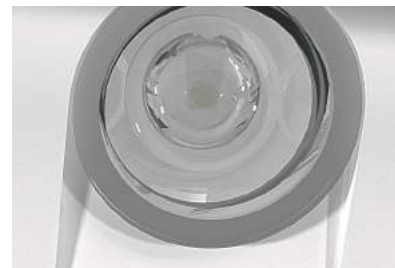

All "+2xLED" version are equipped with 2 additional Power LEDs which arrange perfect light distribution downward in order to get more light on the floor for wall mounting version. Or in case of legend on the diffuser the additional LEDs will arrange enough light level on the floor below the fixture.

Všetky "+2xLED" verzie sú vybavené 2 prídavnými výkonnými LED, ktoré zabezpečujú osvetlenie podlahy v prípade montáže svietidla na stenu (napr nad dvere), čo môže byť s výhodou použité aj v kombinácii s piktoqramom. Hlavné LED nasvietia piktoqram (smer únikovej cesty), spodné 2 LED zabezpečia nasvietenie únikovej cesty na dosiahnutie 1lx.

Page No.32

### AUTOTEST -AT NM/M

Type	Version	Duration	Light Source	Light Flux / Emergency mode	Battery	Order Code	Weight
MULTITREND2-AT.1h	NM/M	1h	LED	430 lm / 310 lm	LiFePo4 6,4V/1,0Ah	277-B-300-04-00-00	1,6 kg
MULTITREND2-AT.3h	NM/M	3h	LED	430 lm / 310 lm	LiFePo4 6,4V/2,0Ah	277-B-301-04-00-00	1,6 kg
MULTITREND2-AT+2xLED.1h	NM/M	1h	LED	430+110 lm / 310+110 lm	LiFePo4 6,4V/1,0Ah	277-B-302-04-00-00	1,7 kg
MULTITREND2-AT+2xLED.3h	NM/M	3h	LED	430+110 lm / 310+110 lm	LiFePo4 6,4V/2,0Ah	277-B-303-04-00-00	1,8 kg

### DALI Self-Contained

Type	Version	Duration	Light Source	Light Flux / Emergency mode	Battery	Order Code	Weight
MULTITREND2-DALI.1h	NM/M	1h	LED	430 lm / 310 lm	LiFePo4 6,4V/1,0Ah	277-B-309-04-00-00	1,7 kg

Page No.36

### CENTRALTEST -ATXL ELMAX-LOOK

Type	Version	Duration	Light Source	Light Flux / Emergency mode	Battery	Order Code	Weight
MULTITREND2-ATXL.1h	NM/M	1h	LED	430 lm / 310 lm	LiFePo4 6,4V/1,0Ah	277-B-304-04-00-00	1,6 kg
MULTITREND2-ATXL.3h	NM/M	3h	LED	430 lm / 310 lm	LiFePo4 6,4V/2,0Ah	277-B-305-04-00-00	1,7 kg
MULTITREND2-ATXL+2xLED.1h	NM/M	1h	LED	430+110 lm / 190+110 lm	LiFePo4 6,4V/1,0Ah	277-B-306-04-00-00	1,7 kg
MULTITREND2-ATXL+2xLED.3h	NM/M	3h	LED	430+110 lm / 190+110 lm	LiFePo4 6,4V/2,0Ah	277-B-307-04-00-00	1,9 kg

Page No.38

### Wireless CENTRALTEST ELMAX-WIRELESS

Type	Version	Duration	Light Source	Light Flux / Emergency mode	Battery	Order Code	Weight
MULTITREND2-ATRF.1h	NM/M	1h	LED	430 lm / 310 lm	LiFePo4 6,4V/1,0Ah	277-B-316-04-00-00	1,7 kg
MULTITREND2-ATRF.3h	NM/M	3h	LED	430 lm / 310 lm	LiFePo4 6,4V/2,0Ah	277-B-317-04-00-00	1,8 kg
MULTITREND2-ATRF+2xLED.1h	NM/M	1h	LED	430+110 lm / 310+110 lm	LiFePo4 6,4V/1,0Ah	277-B-318-04-00-00	1,8 kg
MULTITREND2-ATRF+2xLED.3h	NM/M	3h	LED	430+110 lm / 310+110 lm	LiFePo4 6,4V/2,0Ah	277-B-319-04-00-00	1,9 kg

### DALI CENTRAL BATTERY (CBS)

Type	Version	Light Source	Light Flux	Order Code	Weight
C.TRENDLUX2-DALI 230V AC	DALI CBS	LED	650 lm	277-B-322-00-00-00	1,3 kg

Page No.44

### CENTRAL BATTERY (CBS)

Type	Version	Light Source	Light Flux	Order Code	Weight
C.TRENDLUX2/230V AC/DC	CBS NON-ADDRESSABLE	LED	540 lm	277-B-312-00-00-00	1,3 kg
C.TRENDLUX2/24V AC/DC	CBS NON-ADDRESSABLE	LED	540 lm	277-B-313-00-00-00	1,3 kg
C.TRENDLUX2+2xLED/230V AC/DC	CBS NON-ADDRESSABLE	LED	540+110 lm	277-B-314-00-00-00	1,4 kg
C.TRENDLUX2+2xLED/24V AC/DC	CBS NON-ADDRESSABLE	LED	540+110 lm	277-B-315-00-00-00	1,4 kg

Page No.40

### Addressable CENTRAL BATTERY (CBS) -ATXP ELMAX-PATROLUX

Type	Version	Light Source	Light Flux	Order Code	Weight
C.TRENDLUX2-ATXPR/230V AC/DC	ATXP CBS ADDRESSABLE	LED	540 lm	277-B-308-00-00	1,3 kg
C.TRENDLUX2-ATXPR+2LED/230V AC/DC	ATXP CBS ADDRESSABLE	LED	540+110 lm	277-B-310-00-00	1,5 kg

Look up pages No. 210-217 for 1lx Spacing tables  
Pozri str.210-217 pre rozmiestnenie svietidiel na dosiahnutie 1lx

# ACCESSORIES TRENDLUX2

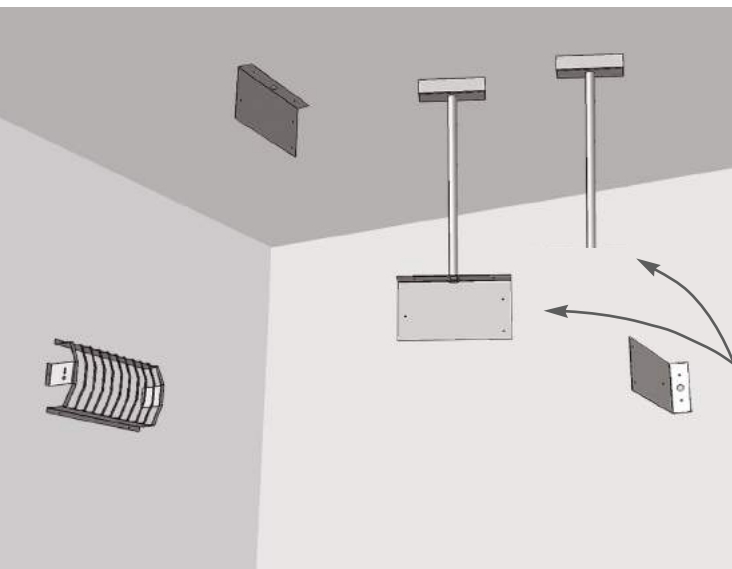

### Options:

- Foil legend legend ISO7010 (must be ordered separately, order codes below)
- Viewing Distance: 35m
- Legend luminance >500cd/m<sup>2</sup> (white)

### Príplatky:

- foliový piktogram podľa ISO7010 (musíte objednať samostatne-vid obj.kódy nižšie)
- rozoznatelnosť piktogramu: 35m
- jas piktogramu >500cd/m<sup>2</sup> (white)

Optional Item / Príplatok	Order Code / Objednávaci kód
Foil legend "H" / pikto fólia typ "H"	277-B-103-01-00
Foil legend "I" / pikto fólia typ "I"	277-B-104-01-00
Foil legend "J" / pikto fólia typ "J"	277-B-105-01-00
Foil legend "K" / pikto fólia typ "K"	277-B-107-01-00
Foil legend "L" / pikto fólia typ "L"	277-B-108-01-00
Foil legend "M" / pikto fólia typ "M"	277-B-109-01-00
Foil legend "N" / pikto fólia typ "N"	277-B-110-01-00
Foil legend "O" / pikto fólia typ "O"	277-B-111-01-00
Foil legend "Z1" / pikto fólia typ "Z1"	277-B-111-07-00
Foil legend "Z2" / pikto fólia typ "Z2"	277-B-111-08-00

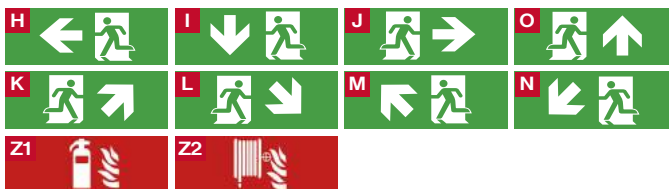

### Options:

- Semi-recessed mounting accessories

### Príplatky:

- výbava pre polozapustenú montáž do stropu

Optional Item / Príplatok	Order Code / Objednávaci kód
Semi-recessed mouting accessories	277-B-210-01-00
Výbava pre polozapustenú montáž do stropu	277-B-210-01-00



Recessed version mounting hole: 320x152 mm  
Rozmer montážneho otvoru: 320x152 mm

### Options:

- Wall / Ceiling / Pendant mounting bracket
- Protective Steel Cage

### Príplatky:

- nástenná / stropná / závesná konzola
- ochranný kôš

Optional Item / Príplatok	Order Code / objednávaci kód
Wall mounting bracket / nástenná konzola	277-B-200-01-00
Ceiling mounting bracket / stropná konzola	277-B-201-01-00
Ceiling bracket 0,5m / závesná konzola 0,5m	277-B-202-01-00
Ceiling bracket 1,0m / závesná konzola 1,0m	277-B-203-01-00
Ceiling bracket 1,5m / závesná konzola 1,5m	277-B-204-01-00
Pendant bracket 0,5m / závesná konzola 0,5m	277-B-207-01-00
Pendant bracket 1,0m / závesná konzola 1,0m	277-B-208-01-00
Pendant bracket 1,5m / závesná konzola 1,5m	277-B-209-01-00
Protective stell cage / ochranný kôš	277-B-205-01-00

Train station area emergency lighting application



Light source	LED 5000K >500cd/m <sup>2</sup> (white luminance) >200cd/m <sup>2</sup> (average luminance)
Installed load	5.8W/6.1VA (maintained M) 2.0W/3.9VA (non-maintained NM) 6.3W/6.5VA (CBS)
Protection type	IP65 IK10
Housing material	Impact resistant polycarbonate
Viewing distance	35m

# CEILING MOUNTING TRENDLUX2-TOP

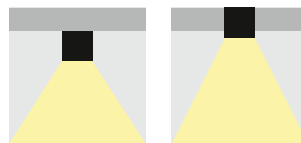

• Equisite IK10 IP65 design surface or semi-recessed mounted powerful double-sided LED fixture with perfect light distribution for non-maintained/maintained (NM/M) or centralised (C) emergency lighting available in all following versions:

- **AUTOTEST** (-AT)
- **DALI**
- **CENTRALTEST** (-ATXL) for ELMAX LOOK system (look up pages No.36)
- **Wireless CENTRALTEST** (-ATRF) for ELMAX-ATRF system (page No.38)
- **CENTRAL BATTERY** (C.TRENDLUX) for **non-addressable CBS** (page No.44)
- **CENTRAL BATTERY** (-ATXP) for system **ELMAX-PATROLUX & Addressable CBS** (look up also page No.40)
- Conforming to the requirement of EN60598-2-22, EN1838, EN62034
- Design: PC impact resistant body IK10

• kompaktné a elegantné výkonné núdzové svietidlo s perfektnou distribúciou svetla pre netrvalé (NM) alebo pre trvalé/netrvalé (NM/M) alebo (C) centrálné napájané núdzové osvetlenie dostupné vo verziách pre:

- **AUTOTEST** (-AT) alebo **DALI**
- **CENTRALTEST** (-ATXL) pre systém ELMAX LOOK (pozri str.36)
- **bezdrôtový CENTRALTEST** (-ATRF) pre ELMAX-ATRF systém (str.38)
- **CENTRAL BATTERY** (C.TRENDLUX) pre **neadresovateľné CBS** (str.44)
- **CENTRAL BATTERY** (-ATXP) pre systém **ELMAX-PATROLUX s adresovateľnou CBS** (pozri str. 40)

- spĺňa požiadavky európskej normy EN 60598-2-22, EN1838, EN62034
- konštrukcia: IK10 teleso z nerozbitného PC



#### Input Power:

- 5,8W/ 6,1VA (maintained M)
- 2,0W/ 3,9VA (non-maintained NM)
- 6,3W/ 6,5VA (CBS)

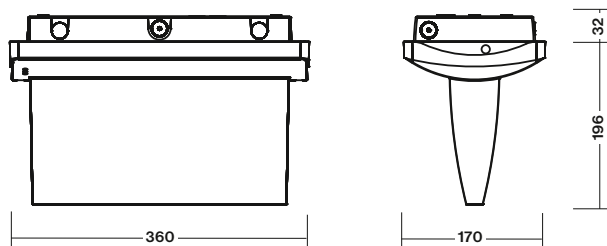

#### STANDARD FEATURES

#### STANDARDNÁ VÝBAVA

- **High efficient MidPower (150lm/W) LONGLIFE LEDs 5000K (>100.000h)**
- **NEW Advanced Electronics**
- **LONGLIFE LiFePo4 battery**
- **Installation Mode** (battery protection, for more details look up page No.51+75)
- **Intelligent battery charging** (intermittent charging, look up page No.No.51+75)
- **DIP Switch** allowing to preset following functions:
  - **ECO Mode** (dimming 10%-100%, for more details look up page No.No.51+75)
  - **ENERGY Saving Mode** (picto illumination 2cd/m<sup>2</sup> or 200cd/m<sup>2</sup>, page 51+75)
- Special mirror effect reflector
- Addressable CENTRALTEST communication module (for ATXL, ATXP only)
- LEDs indicating presence of power supply and signaling failures & TEST button

- **vysoko účinné MidPower LED 5000K (150lm/W) so životnosťou min.100000h**
- **progressívna elektronická jednotka**
- **LONGLIFE LiFePo4 batéria**
- **Inštalčný mód** (ochrana batérie, pozri aj str.51+75)
- **Inteligentné nabíjanie batérie** ("intermittent" nabíjanie, pozri aj str.51+75)
- **DIP prepínač** umožňujúci prednastavenie funkcií:
  - **ECO Mód** (stmievanie 10%-100%, pozri aj str.51+75)
  - **ENERGY Saving Mód** (osvetlenie pikto 2cd/m<sup>2</sup> alebo 200cd/m<sup>2</sup>, pozri str.51+75)
- špeciálny odrazový reflektor so zrkadlovým efektom
- adresovateľný CENTRALTEST komunikačný modul (len pre ATXL, ATXP verzie)
- signalizácia LED a TEST tlačítko

#### OPTIONAL ACCESSORIES

#### PRÍPLATKY

- Non-adhesive legends (look up page No.76)
- Wall mounting or pendant brackets (look up page No.76)
- Semi-recessed mounting accessories (look up page No.76)
- fóliové piktogramy (pozri str.76)
- nástenná alebo stropná závesná konzola (pozri str.76)
- príslušenstvo pre polozapustenú montáž do stropu (pozri str.76)



Optional Foil Legends  
Príplatkový piktogram  
(look up also page No.76)

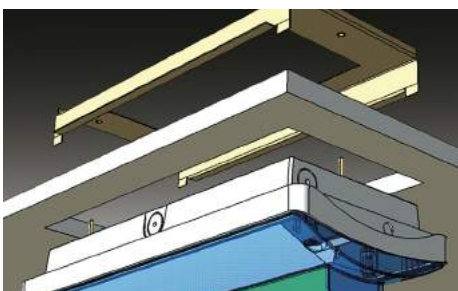

Optional Semi-recessed accessories  
Príplatkové príslušen. pre polozapustenú montáž  
(look up also page No.76)

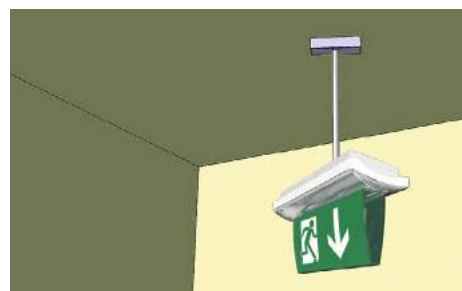

Optional Brackets  
Príplatkové konzoly  
(look up also page No.76)



**SELF-CONTAINED BATTERY VERSIONS**

<b>NORMAL MODE 230V MAINS</b>	<b>EMERGENCY BATTERY MODE</b>	ON OFF [1-8]	<b>DEFAULT SETT./ PREDNASTAVENÉ</b> Full Power
[Icon]	[Icon]	ON OFF [1-8]	<b>ECO MODE 50% (in 230V mode)</b> EMERGENCY MODE LEGEND BRIGHTNESS > 200cd/m <sup>2</sup>
[Icon]	[Icon]	ON OFF [1-8]	<b>ECO MODE 25% (in 230V mode)</b> EMERGENCY MODE LEGEND BRIGHTNESS > 200cd/m <sup>2</sup>
[Icon]	[Icon]	ON OFF [1-8]	<b>ECO MODE 10% (in 230V mode)</b> EMERGENCY MODE LEGEND BRIGHTNESS > 200cd/m <sup>2</sup>
[Icon]	[Icon]	ON OFF [1-8]	<b>ENERGY SAVING (in emerg.mode)</b> LEGEND BRIGHTNESS > 2cd/m <sup>2</sup> JAS PIKTOGRAMU > 2cd/m <sup>2</sup>
[Icon]	[Icon]	ON OFF [1-8]	<b>ENERGY SAVING (in emerg.mode)</b> <b>ECO MODE 50% (in 230V mode)</b> LEGEND BRIGHTNESS > 2cd/m <sup>2</sup>
[Icon]	[Icon]	ON OFF [1-8]	<b>ENERGY SAVING (in emerg.mode)</b> <b>ECO MODE 25% (in 230V mode)</b> LEGEND BRIGHTNESS > 2cd/m <sup>2</sup>
[Icon]	[Icon]	ON OFF [1-8]	<b>ENERGY SAVING (in emerg.mode)</b> <b>ECO MODE 10% (in 230V mode)</b> LEGEND BRIGHTNESS > 2cd/m <sup>2</sup>
[Icon]	<b>INSTALLATION MODE SET UP</b>	ON OFF [1-8]	<b>DEFAULT / PREDNASTAVENÉ</b> OFF - ACTIVATED ON - DEACTIVATED
[Icon]	<b>NON-MAINTAINED / MAINTAINED MODE SET UP</b>	ON OFF [1-8]	<b>DEFAULT / PREDNASTAVENÉ</b> ON - MAINTAINED OFF - NON-MAINTAINED
[Icon]	<b>AUTOTEST / CENTRALTEST MODE SET UP</b>	ON OFF [1-8]	<b>DEFAULT / PREDNASTAVENÉ</b> OFF - AUTOTEST ON - CENTRALTEST
[Icon]	<b>NO-AUTOTEST MODE SET UP</b>	ON OFF [1-8]	<b>DEFAULT / PREDNASTAVENÉ</b> OFF - AUTOTEST ACTIVE ON - NO-AUTOTEST

**CBS CENTRAL BATTERY VERSIONS**

<b>CBS CENTRAL BATTERY</b>	ON OFF [1-8]	<b>FULL POWER</b> LEGEND BRIGHTNESS > 200cd/m <sup>2</sup> JAS PIKTOGRAMU > 200cd/m <sup>2</sup>
[Icon]	ON OFF [1-8]	<b>ECO MODE 50%</b>
[Icon]	ON OFF [1-8]	<b>ECO MODE 25%</b>
[Icon]	ON OFF [1-8]	<b>ECO MODE 10%</b> LEGEND BRIGHTNESS > 2cd/m <sup>2</sup> JAS PIKTOGRAMU > 2cd/m <sup>2</sup>

**TO SEE THE CHANGE EITHER PUSH THE TEST BUTTON OR DISCONNECT THE FIXTURE FROM BOTH THE MAINS 230V AND BATTERY**

Po prestavení stlačte TEST alebo odpojte batériu a pripojenie na sieť na aktiváciu zmeny



Most advanced "V" twin LED light source with perfect light distribution. It is equipped with high efficient (150lm/W) LONGLIFE LEDs with the lifetime min 100.000h

Page No.32

**AUTOTEST -AT NM/M**

Type	Version	Duration	Light Source	Light Flux / Emergency mode	Battery	Order Code	Weight
MULTITREND2-TOP-AT.1h	NM/M	1h	LED	430 lm / 310 lm	LiFePo4 6,4V/1,0Ah	277-B-400-04-00-00	1,8 kg
MULTITREND2-TOP-AT.3h	NM/M	3h	LED	430 lm / 310 lm	LiFePo4 6,4V/2,0Ah	277-B-401-04-00-00	1,9 kg

**DALI Self-Contained**

Type	Version	Duration	Light Source	Light Flux / Emergency mode	Battery	Order Code	Weight
MULTITREND2-TOP-DALI.1h	NM/M	1h	LED	430 lm / 310 lm	LiFePo4 6,4V/1,0Ah	277-B-409-04-00-00	1,9 kg

Page No.36

**CENTRALTEST -ATXL ELMAX-LOOK**

Type	Version	Duration	Light Source	Light Flux / Emergency mode	Battery	Order Code	Weight
MULTITREND2-TOP-ATXL.1h	NM/M	1h	LED	430 lm / 310 lm	LiFePo4 6,4V/1,0Ah	277-B-402-04-00-00	1,9 kg
MULTITREND2-TOP-ATXL.3h	NM/M	3h	LED	430 lm / 310 lm	LiFePo4 6,4V/2,0Ah	277-B-403-04-00-00	2,0 kg

Page No.38

**Wireless CENTRALTEST ELMAX-WIRELESS**

Type	Version	Duration	Light Source	Light Flux / Emergency mode	Battery	Order Code	Weight
MULTITREND2-TOP-ATRF.1h	NM/M	1h	LED	430 lm / 310 lm	LiFePo4 6,4V/1,0Ah	277-B-407-04-00-00	1,7 kg
MULTITREND2-TOP-ATRF.3h	NM/M	3h	LED	430 lm / 310 lm	LiFePo4 6,4V/2,0Ah	277-B-408-04-00-00	1,8 kg

**DALI CENTRAL BATTERY (CBS)**

Type	Version	Light Source	Light Flux	Order Code	Weight
C.TRENDLUX2-TOP-DALI 230V AC	DALI CBS	LED	650 lm	277-B-410-04-00-00	1,3 kg

Page No.44

**CENTRAL BATTERY (CBS)**

Type	Version	Light Source	Light Flux	Order Code	Weight
C.TRENDLUX2-TOP/230V AC/DC	CBS NON-ADDRESSABLE	LED	540 lm	277-B-404-00-00-00	1,3 kg
C.TRENDLUX2-TOP/24V AC/DC	CBS NON-ADDRESSABLE	LED	540 lm	277-B-405-00-00-00	1,3 kg

Look up pages No. 210-217 for 1lx Spacing tables  
Pozri str.210-217 pre rozmiestnenie svetidiel na dosiahnutie 1lx

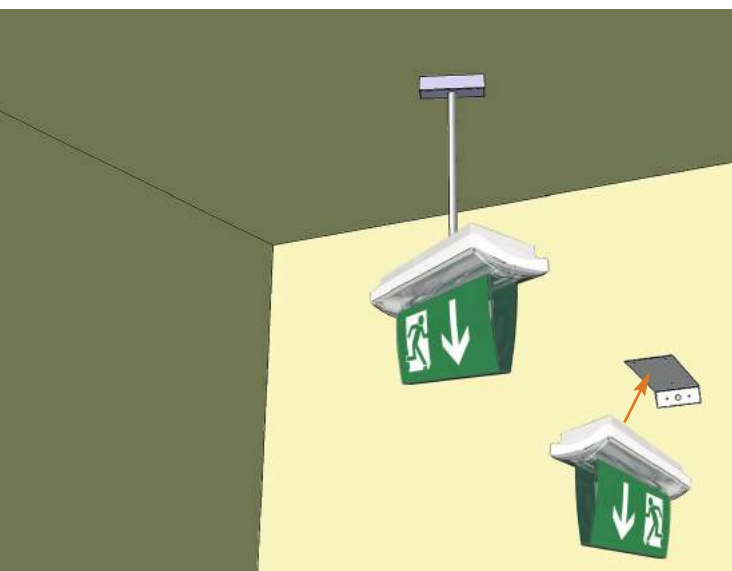
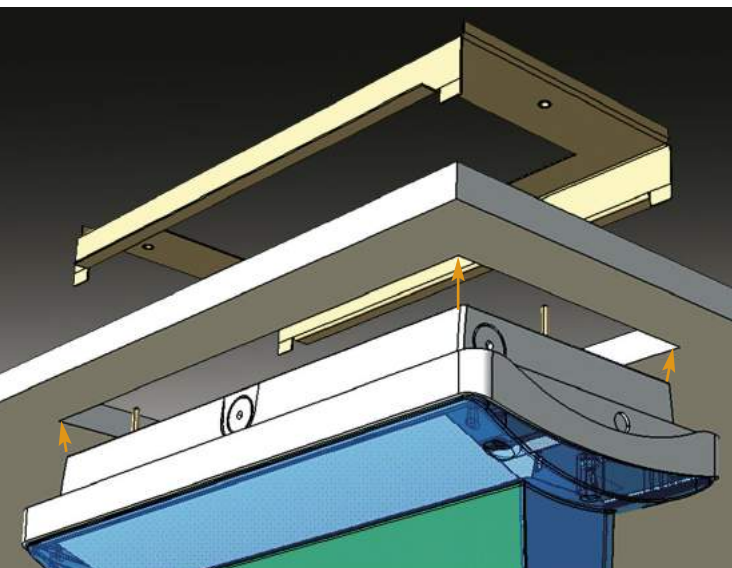

**Options:**

- Foil pictogram/legend complying ISO7010 (must be ordered separately, order codes below)
- Viewing Distance: 35m
- Legend luminance >500cd/m<sup>2</sup> (white)

**Príplatky:**

- foliový piktoqram v súlade s ISO7010 (musí sa objednať samostatne-vid' obj.kódy nižšie)
- rozoznatelnosť piktoqramu: 35m
- jas piktoqramu >500cd/m<sup>2</sup> (biela)

Optional Item / Príplatok	Order Code / Objednávaci kód
Foil legend "H" / pikto fólia typ "H"	277-B-103-01-00
Foil legend "I" / pikto fólia typ "I"	277-B-104-01-00
Foil legend "J" / pikto fólia typ "J"	277-B-105-01-00
Foil legend "K" / pikto fólia typ "K"	277-B-107-01-00
Foil legend "L" / pikto fólia typ "L"	277-B-108-01-00
Foil legend "M" / pikto fólia typ "M"	277-B-109-01-00
Foil legend "N" / pikto fólia typ "N"	277-B-110-01-00
Foil legend "O" / pikto fólia typ "O"	277-B-111-01-00
Foil legend "Z1" / pikto fólia typ "Z1"	277-B-111-07-00
Foil legend "Z2" / pikto fólia typ "Z2"	277-B-111-08-00

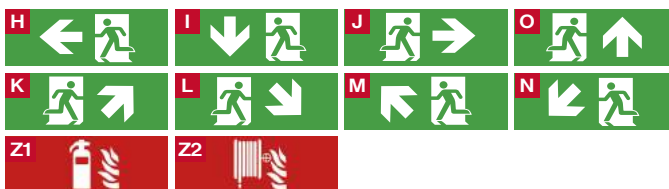
**Options:**

- Semi-recessed mounting accessories

**Príplatky:**

- výbava pre polozapustenú montáž do stropu

Optional Item / Príplatok	Order Code / Objednávaci kód
Semi-recessed mouting accessories	277-B-210-01-00
Výbava pre polozapustenú montáž do stropu	277-B-210-01-00

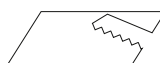

Recessed version mounting hole: 320x152 mm  
Rozmer montážneho otvoru: 320x152 mm

**Options:**

- Wall / Ceiling Pendant mounting brackets

**Príplatky:**

- nástenná / stropná závesná konzola

Optional Item / Príplatok	Order Code / objednávaci kód
Wall mounting bracket / nástenná konzola	277-B-200-01-00
Pendant bracket 0,5m / závesná konzola 0,5m	277-B-207-01-00
Pendant bracket 1,0m / závesná konzola 1,0m	277-B-208-01-00
Pendant bracket 1,5m / závesná konzola 1,5m	277-B-209-01-00

# CEILING MOUNTING TRENDLUX2-TOP

Light source	LED 5000K >500cd/m <sup>2</sup> (white luminance) >200cd/m <sup>2</sup> (average luminance)
Installed load	5.8W/6.1VA (maintained M) 2.0W/3.9VA (non-maintained NM) 6.3W/6.5VA (CBS)
Protection type	IP65 IK10
Housing material	Impact resistant polycarbonate
Viewing distance	35m

Industrial Area Emergency Lighting Application

