

Socket / Socket with earthing contact / Covered Socket with earthing contact
Socket with pin earthing contact

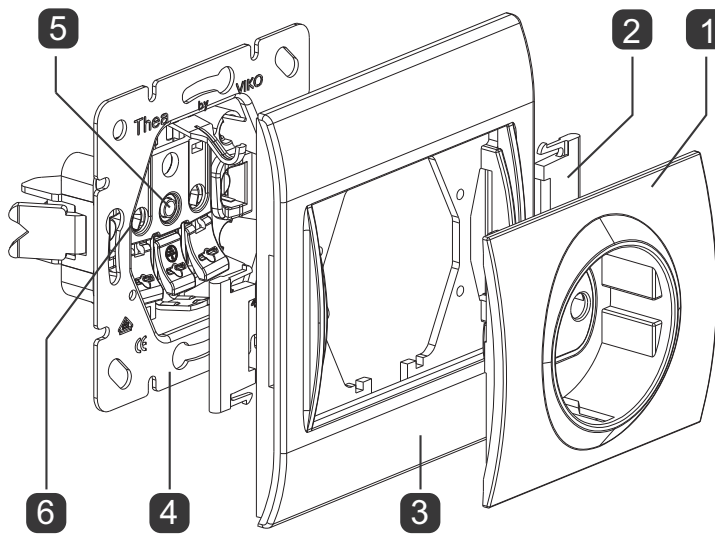

- 1) Cover
- 2) Transparent part
- 3) Frame
- 4) Base
- 5) Screw of the cover
- 6) Screw of the claw

Dual Socket / Dual Socket with earthing contact

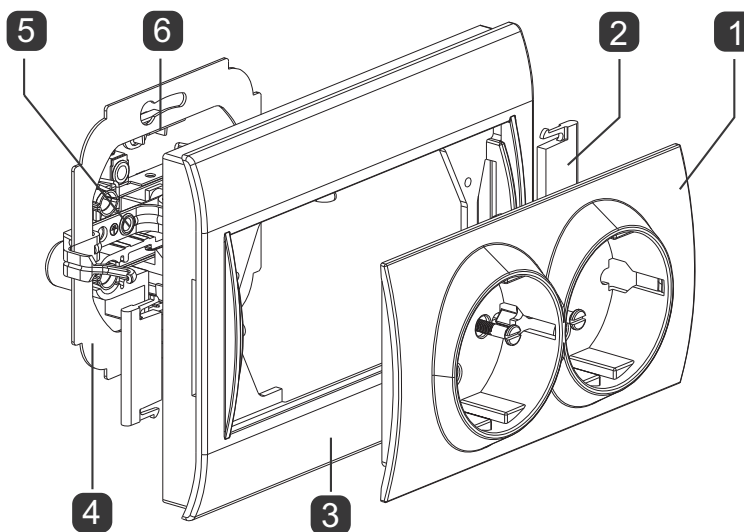

Models:

- Socket, Socket with earthing contact, Covered Socket with earthing contact, Socket with pin earthing contact, Dual Socket, Dual Socket with earthing contact

Technical Characteristics:

- 16 A 250 V ~
- **Fast Connection:** Fast and easy mounting with screwless connecting base and cover screw with two turns (Dual Socket and Dual Socket with earthing contact products are connected with screws)
- **Child Protection:** Does not open and avoids access to the live parts unless

an equal force is applied on both socket housings at the same moment.

- **Protective Cover :** Covered type with earthing contact sockets designed for wet environments such as bathrooms, etc., prevent the penetration of water splash into the socket.

Assembly Method:

- In Phase, Neutral and Earthing arriving from the way, (Screwless type sockets) the insulation of the outer shield of the cables are opened at about 14 mm, and the cables is connected to the base.
- The base is placed in the mounting

box and the claw screws are tightened with an appropriate screw driver.

- The transparent parts are placed in the slot on the sides of the frame
- The screw of the cover on the base is displaced (There are two cover screws on the dual socket and the dual socket with earthing contact)
- The cover and the frame are placed on the base as shown in the figure.
- The cover and the frame group are fixed on the base by the screw and the assembly work is completed.

